

20
22



THE HOME OF REBAR HANDLING MACHINES



MANUAL

TYB-D35

Contact our after sales department for any questions or concerns

www.cnbmachinery.com cnbsales@cnbmachinery.com (02) 8824-6391 / 6386



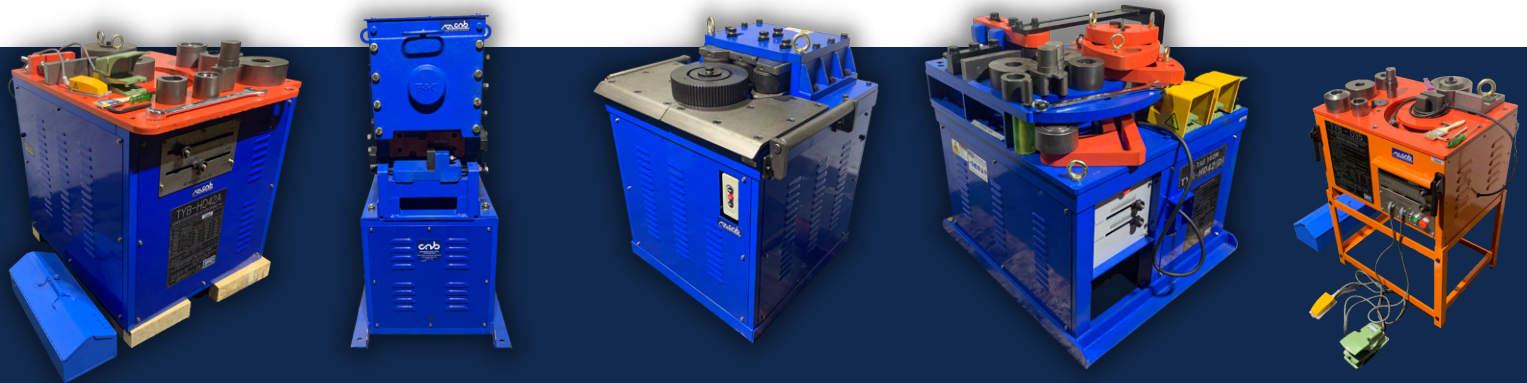

TABLE OF CONTENTS

Machine Specifications -----	03
Machine Introduction -----	05
Basic Guidelines to Follow -----	06
Combinations of Rollers-----	09
Things to Avoid -----	11



TYB-D35

General Bender

Machine Specification

Bending Angle

180° / 5 seconds

Bending Capacity

10-32mm rebar (0.375-1.27 inches)

Motor

2.1kW (2HP)

Power Requirements

Single phase, 220V-230V 60HZ (factory set up)

Weight

180kg / 396lb

Dimension

(L) 673mm (W) 500mm (H) 447mm

Number of rebars the machine can bend at once

Diameter of Rebar

25-32mm

19-22mm

16mm

13mm

10mm

No. of Rebars

1 rebar

2 rebars

3 rebars

4 rebars

6 rebars



Maximum Bending Angle of Rebars

Diameter of Rebar	32mm	22-25mm	19mm	16mm	13mm	10mm
Maximum Angle of Bend	180°	180°	180°	180°	180°	180°

Exchange Roller and R-Jig Specification

Diameter of Rebar	Fixed Roller	Rotating Roller
10-13mm	Jig	175mm
16-19mm	68mm	175mm
22-25mm	96mm	175mm
22-25mm	96mm	108mm
29mm	128mm	108mm
32mm	128mm	108mm

Power Cable Requirements

Power Supply / Power	Standard Sizes / Length	Excess Length
220-230V, single phase, 2HP, 2.2KW (2 motors)	#12 AWG / 3.5mm wires, Max length from Main Circuit Breaker 20 Amps is 30 meters	When the wire exceeds 30 meters, replace the wires to a bigger size depending on the length requirements to avoid power fluctuation or voltage drop.

Machine Introduction - Tool Box

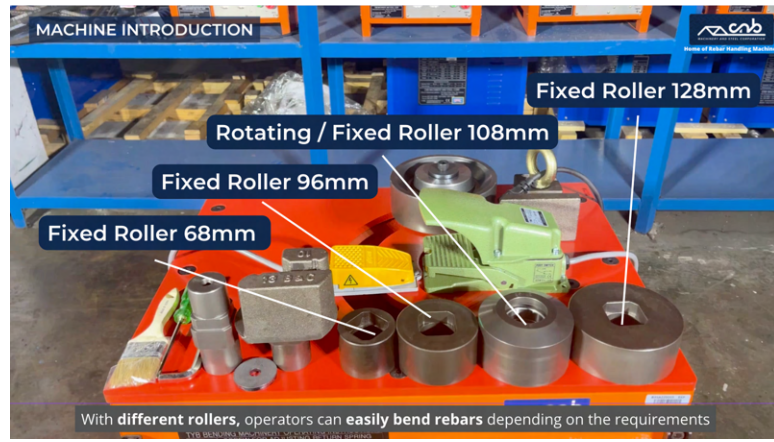
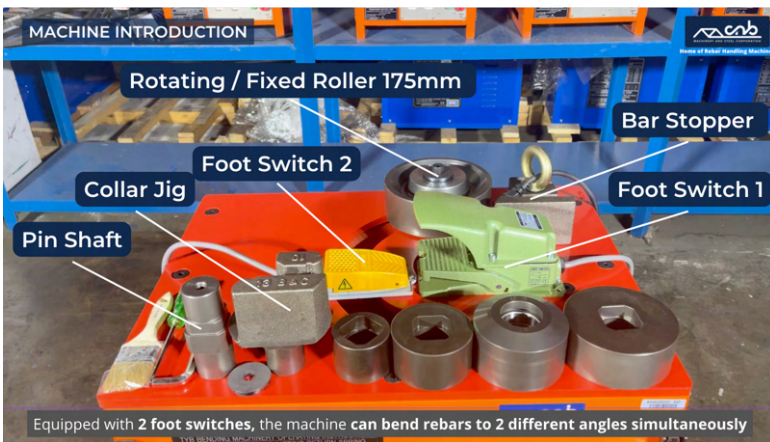

Our TYB-D35 machine comes with a complete toolbox, rollers and collar jig. The toolbox contains, a screw driver, wrench, brush, 2 footswitches 4 rollers, 1 pin shaft and a collar jig.

Machine Introduction - Dynamics of the machine

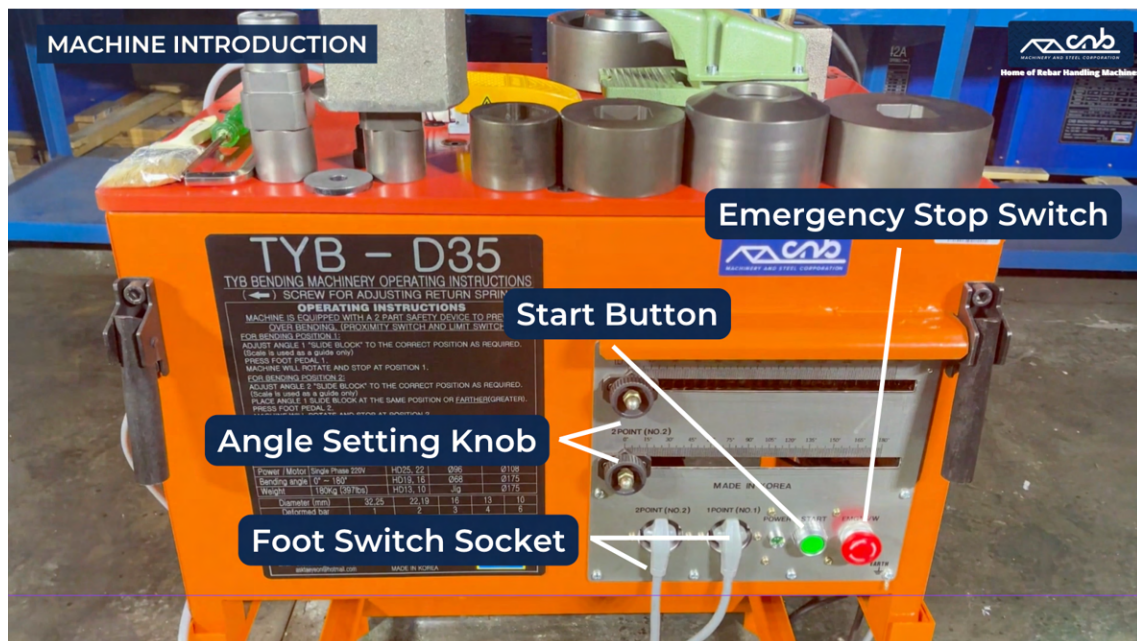

Our TYB-D35 is a powerful yet very simple to use machine. It is equipped with 2 angle setting knobs that allows the machine to bend into 2 different angles simultaneously. It also comes with 2 foot switch sockets for the 2 foot switches. There is an emergency switch that can be used to pause the machine if there is an unusual occurrence for safety.

Power Supply Guidelines



Make sure to check that the power supply is stable between 220-230V.
The machine's power supply can be supplied by plugging it in to a socket or you may choose to tap directly from the main circuit breaker.
We recommend that you would use a thicker power cable to avoid power fluctuation.

Proper Rebar Alignment

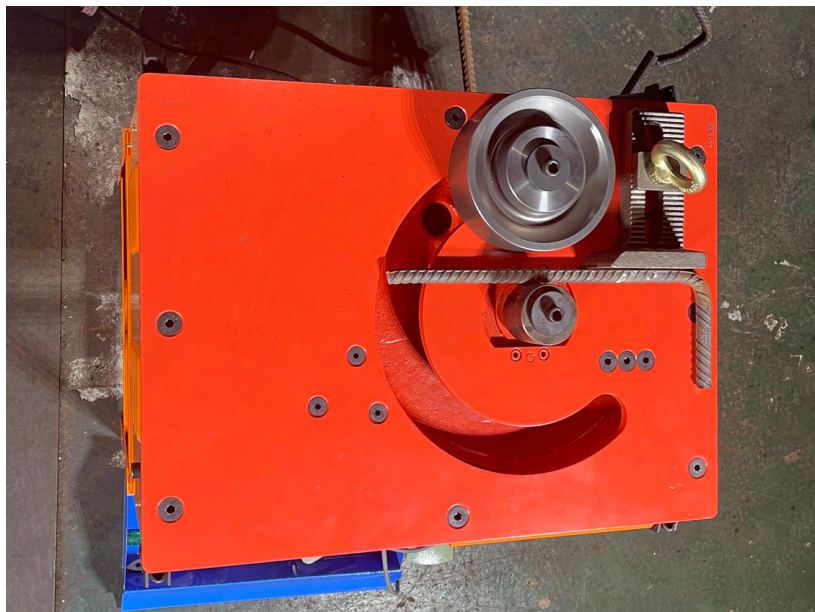

Before proceeding with the bending of the rebars, make sure that the bar stopper, collar jig, and rollers are aligned to the rebar for it to be secured and properly bent.

Emergency Switch Guidelines - Activation



Press the Emergency Switch Button when you encounter something unusual with the machine for your safety. Pressing the button will make the roller return to its starting position. The machine will also be on pause mode while the button while the button is still pressed.

Emergency Switch Guidelines - Release

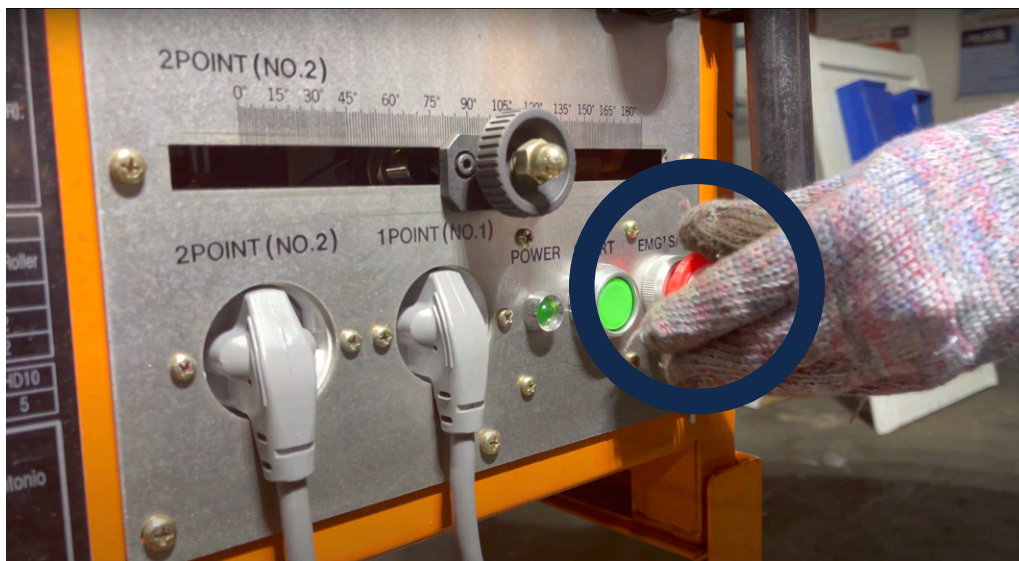

As mentioned, the machine will not be operating if the Emergency Switch Button is pressed. In order to activate the machine again for bending, simply twist the button clockwise. This will activate the machine for bending again.

Point 1 and Point 2 Guidelines



The angles found in the protractor plate are just references for Point 1 and 2. Operators must undergo trial and error by adjusting the angle setting knobs until the **right angle** is bent. Bending the rebar into 2 angles simultaneously like stirrups is possible by setting Point 1 into 180° and Point 2 into 90°.

NOTE: The angle set in Point 1 **MUST** be the bigger angle for bending while the angle set in Point 2 **MUST** be the smaller angle for bending.

Foot Switch Usage



The green foot switch located on the left is used for the bending of rebar with the angle of Point 1. The yellow foot switch located on the right is used for the bending of rebar with the angle of Point 2.

Combination for the bending of 10mm rebars

COMBINATION #1
FOR REBAR DIAMETER 10MM
COLLAR JIG "10" SIDE



Then slide in the Collar Jig (10 side) and adjust the bar stopper to the rebar size to stabilize

COMBINATION #1
FOR REBAR DIAMETER 10MM
COLLAR JIG "10" SIDE

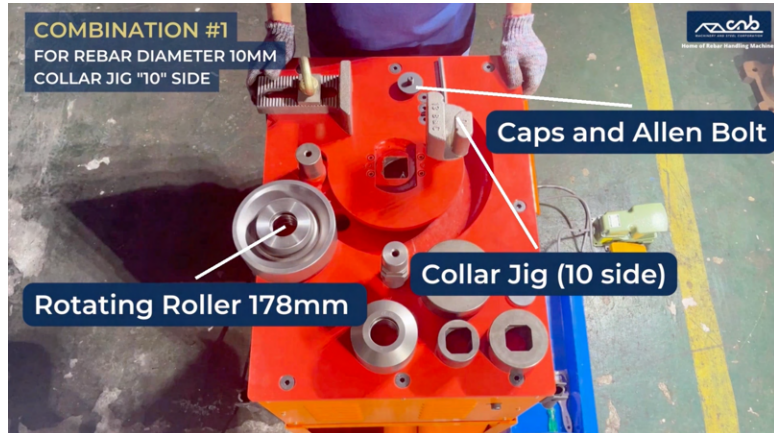

Combination for the bending of 12mm rebars

COMBINATION #1.1
FOR REBAR DIAMETER 13MM
COLLAR JIG "13" SIDE



To bend 12mm rebars, lift the collar jig and make sure the "13 B&C" side is facing outwards

COMBINATION #1.1
FOR REBAR DIAMETER 13MM
COLLAR JIG "13" SIDE

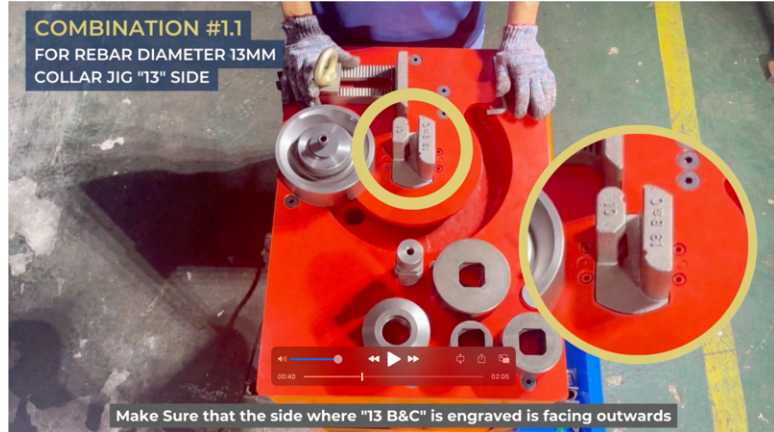

Make Sure that the side where "13 B&C" is engraved is facing outwards

Combination for the bending of 16-25mm rebars

COMBINATION #2
FOR REBAR DIAMETER 16-19MM
68MM FIXED ROLLER & PIN SHAFT

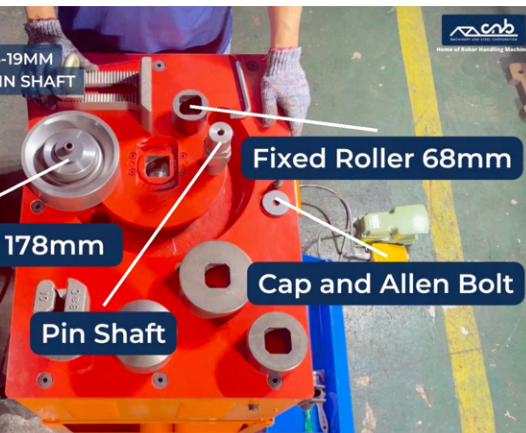

COMBINATION #2
FOR REBAR DIAMETER 16-19MM
68MM FIXED ROLLER & PIN SHAFT

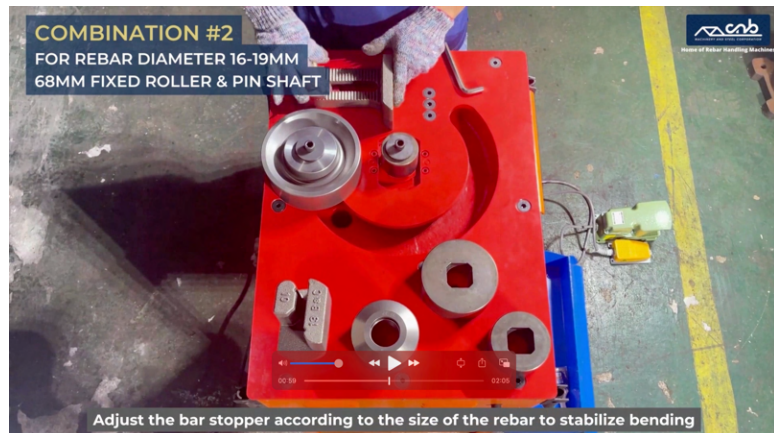

Adjust the bar stopper according to the size of the rebar to stabilize bending

Combination for the bending of 22-25mm rebars

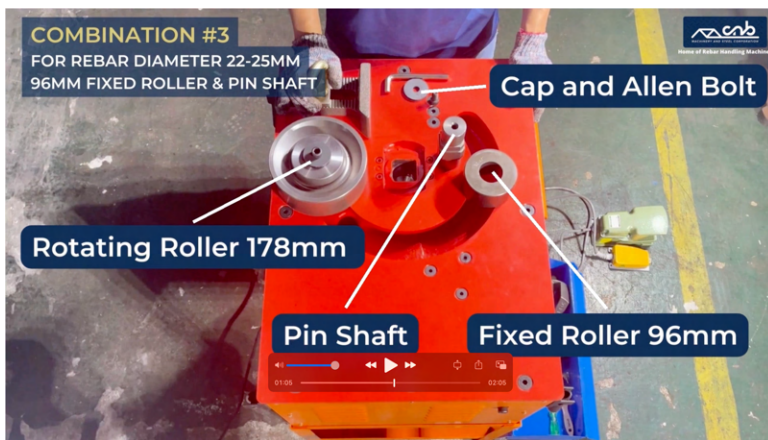

Alternative Combination for 22-25mm rebar bending



Combination for the bending of 29-32mm rebars

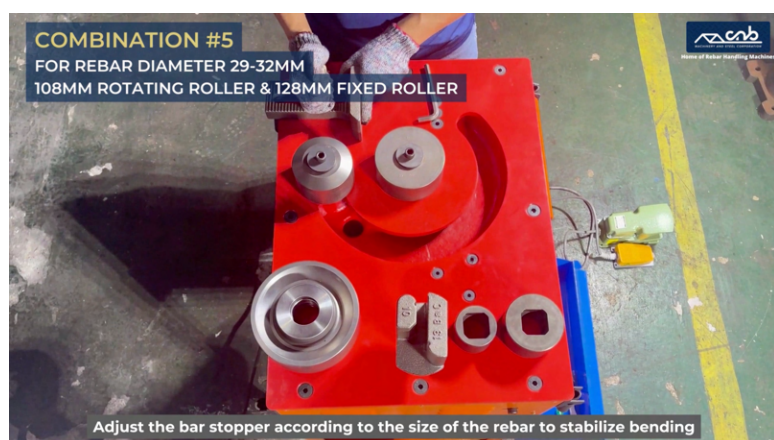
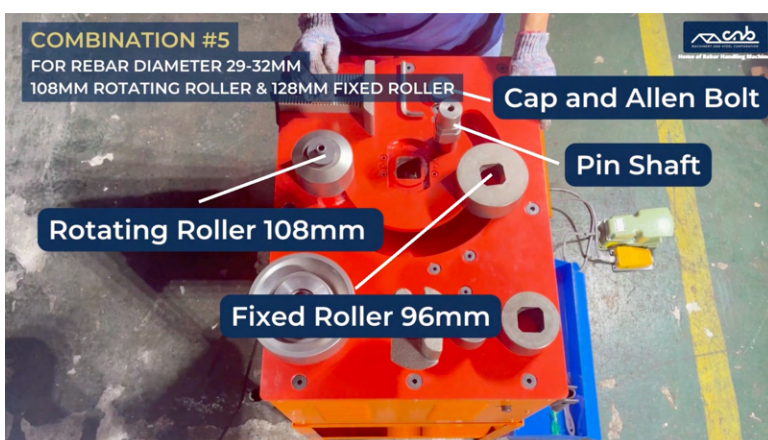

Things to Avoid

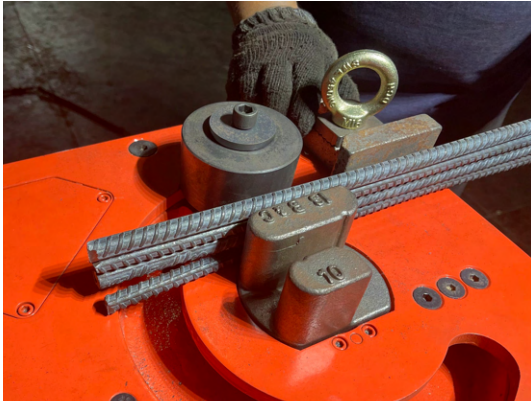

DO NOT load the rebars at between the roller and the collar jig when bending. This will lead to the **collar jig to break** as the pressure of the bending will **damage the collar jig**. The proper way to bend 10-12mm rebars is to place the rebars in the collar jig.

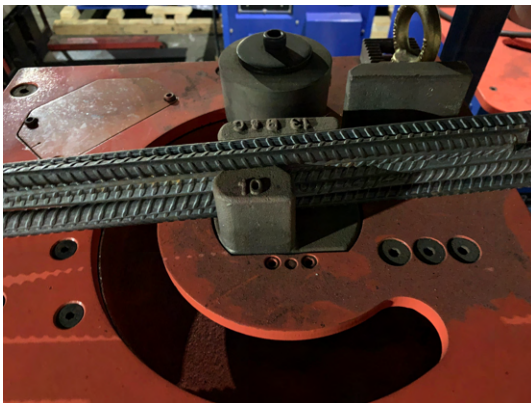

DO NOT overload the collar jig or roller more than the number of rebars indicated in the instructions as it will cause the collar jig or rollers to break which can end up hurting the machine operators as well.



DO NOT step on both foot switches at the same time as it will cause the machine to **malfunction**. It may cause **electrical and mechanical damage** to the machine.

THANK YOU, AND WE LOOK FORWARD TO BE PARTNERS WITH YOU

Route from Evia Lifestyle Center

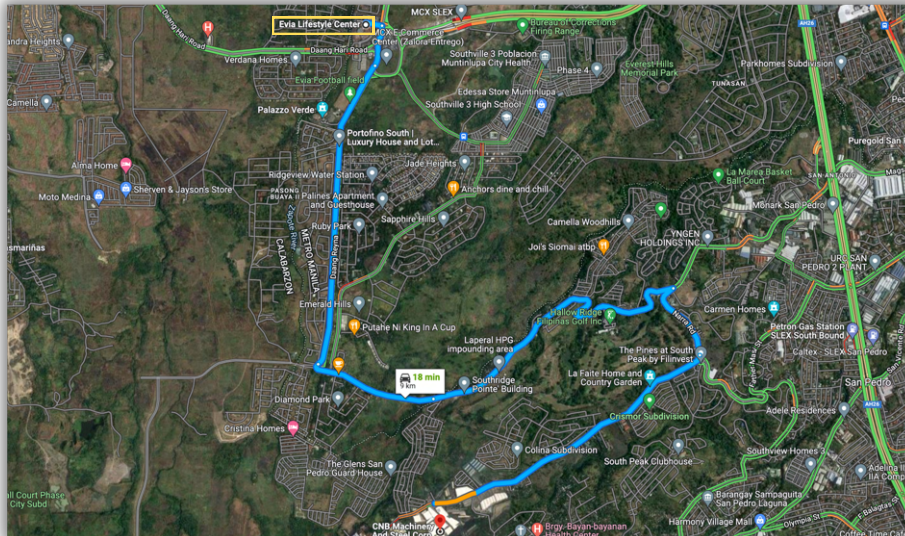

Route from San Pedro Exit South

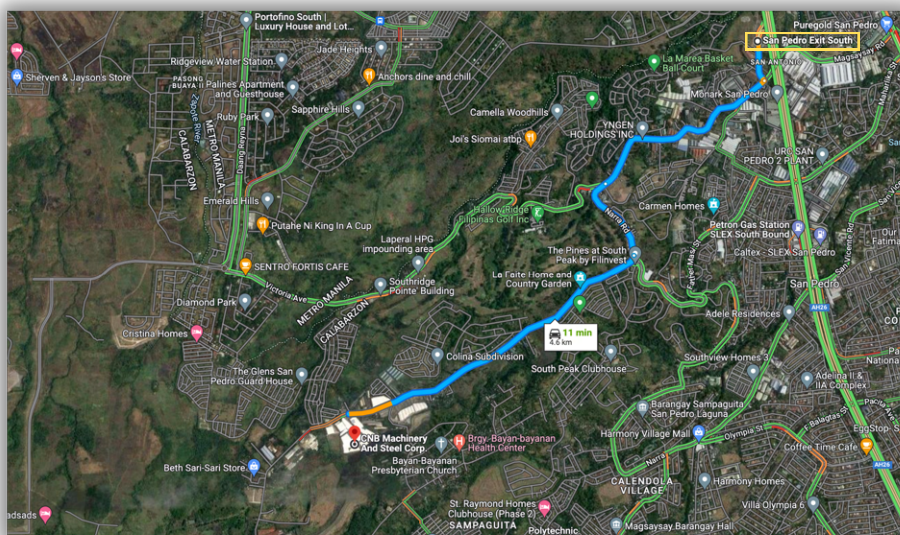

SKETCH OF COMPOUND

Entrance of the Industrial Compound



GEOLAND INDUSTRIAL COMPOUND ENTRANCE

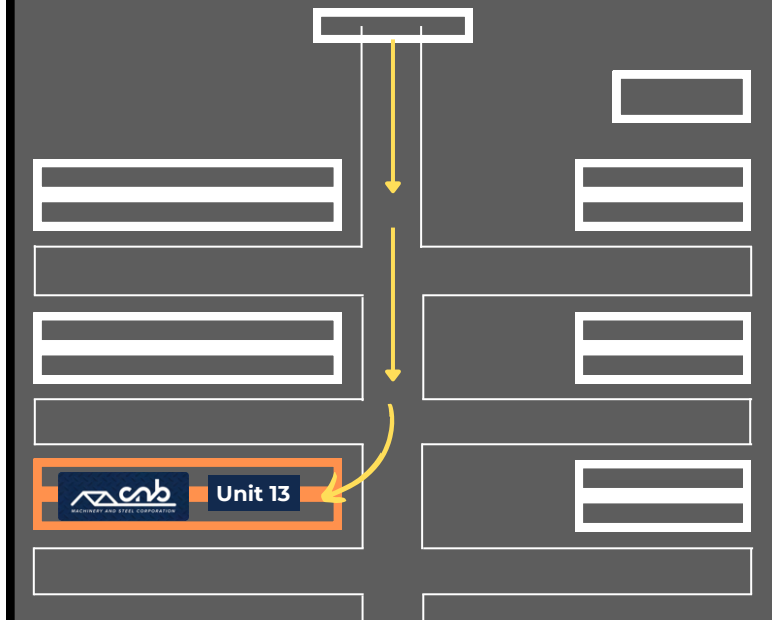

CNB MACHINERY AND STEEL CORPORATION

Unit #13 Geoland Industrial Compound 7760
Narra Road Barangay San Antonio San Pedro Laguna
TEL: (02) 8824-6386/8824-6389/8824-6346/8824-6391
FAX: (02) 8857-2346
E-mail: cnbsales@cnbmachinery.com
Website: www.cnbmachinery.com

The Home of Rebar Handling Machines

